

Rich High School

Security Breezeway

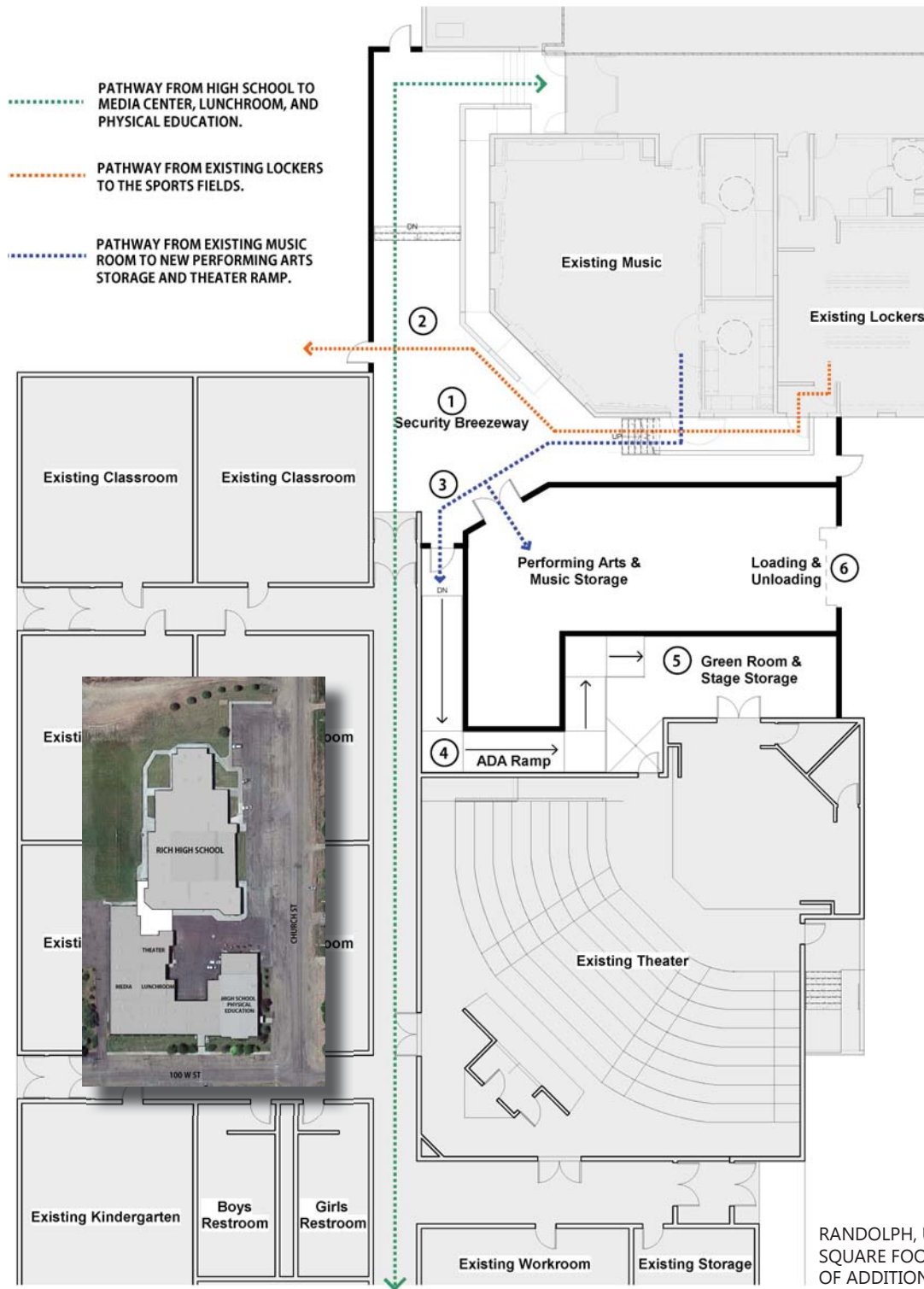

FLOOR PLAN 1/8" = 1'-0"

RANDOLPH, UTAH
 SQUARE FOOTAGE
 OF ADDITION:
 4,250 SF

BREEZEWAY CONNECTION

Connecting the existing buildings creates covered and protected avenue, eliminating the need for students to travel outside.

SHELTER

Breezeway connection gives a more public lobby to enter existing buildings and the theater.

SECURITY

By locking doors to the theater ramp, loading docks and exterior, the school staff has the ability to have more control by limiting access to the public.

THEATER RAMP

ADA ramp creates an accessible entrance to the theater stage for props and equipment too large to bring up steps.

EXPANDED BACKSTAGE

The theater has gained a staging space for a green room and storage to support performances.

LOADING/UNLOADING

Overhead door added to the south establishes a secure area for loading and unloading while creating a large space for storage.



FINE ARTS (101)

Located near the stage, the fine arts room will help promote students language and reasoning. Students who have early musical training will develop the areas of the brain related to language and reasoning.

STEM CLASSROOM (102)

Centered around project-based learning, an effective STEM classroom fosters a positive culture that allows students to problem solve, collaborate, create, test ideas and build with their hands.

SPECIAL EDUCATION (103)

With the addition of the storage (103), the existing building gains space to optimize the special education classroom. The existing building also gains much needed space in the lunch room by re-using the existing science room as storage.



STAGE (108)

Adjacent to green room and fine arts room, the ADA accessible ramp allows oversized items to be rolled to the stage level in case of larger performances, chairs can be added to the gym floor supplementing the moveable bleacher seats.

GYM (110)

Moveable bleachers allow for a capacity of 490 seats. Gym has the option of two auxiliary basketball and volleyball courts when bleachers are folded up.

LOCKER ROOMS (117, 127)

Locker rooms can double as team rooms for games, while still keeping restrooms accessible by public. The team rooms can lock during games with an ADA restroom and showers inside.



Rich Middle School

STEM, Fine Arts, & Physical Education Facility Addition

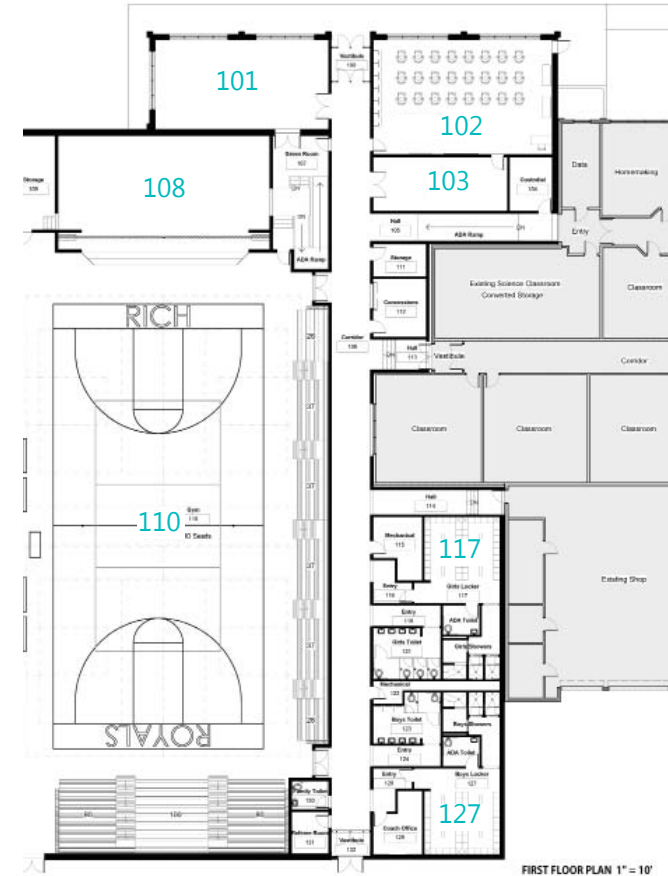

LAKETOWN, UTAH SQUARE FOOTAGE OF ADDITION: 21,710 SF



NORTH ELEVATION